



Airport Identification Beacon (LED)



Airport Identification Beacon

Aeronautical Beacon, multi-LED type, compliant to ICAO Annex 14.

The "Airport Identification Beacon" is the ideal solution when looking for compact and light-weight product, realized with high quality products and patented features. ALS-IDB-LXS light has been designed to be an important support to airfield operations, providing guidance during night operations to pilots and allowing them easily to identify the airstrip, since this light has a flash frequency in Morse Code that corresponds to airport's identification code.

Thanks to reduced dimensions, the light ALS-IDB-LXS can be easily installed on horizontal surfaces and a balance of patented lenses, electronics and mechanical components make this device the most reliable and high-quality LED Aerodrome Identification Beacon available on the market.

Features:

- Based on LED technology
- Patent beacon
- GREEN light - Flashing (Morse Code)
- Intensity: >2.000cd
- Long lifetime >10 years life expectancy
- Low consumption
- Lightweight and compact
- Degree of protection: IP66
- No RF radiations
- Easy to install
- Wind resistance tested at 240km/h (150mph)
- Vibration resistance up to: 80m/s² (10° Mercalli Intensity Scale / 7° Richter Magnitude Scale)
- Fully ICAO compliant (ISO/IEC 17025 accredited third-party laboratory)



Complete System consists of Beacon and Controller.



IDENTIFICATION BEACON





IDENTIFICATION BEACON TECHNICAL SPECIFICATIONS

OPTICAL FEATURES

- Based on LED technology
- GREEN light 2.000cd, night mode
- Airport IATA/ICAO Morse Code Flash
- Horizontal beam radiation 360°
- Vertical beam spread >1°
- PMMA lens
- Light output alignment device

LIGHT MECHANICAL FEATURES

- Anodised aluminium body, painted yellow
- Borosilicate glass cover protection
- Silicon rubber, VMQ
- Base wind collector and internal heat sink for optimum cooling
- Degree of protection: IP66
- Anti-condensation Gore-Tex valve
- Operating temp.: -30°C to +50°C
- Lamp unit weight: 6kg

BOX MECHANICAL FEATURES

- Enclosure material: mild steel, painted RAL 7035
- Surge arrester
- Fault alarm
- Photocell (twilight sensor)
- Overvoltage protection

OPTIONS

- Beacon support bracket
- GPS (Global Position System) syncro
- Yellow flashing light for water aerodromes
- TWIN version: two separate LED circuits in the same fixture (normal + stand-by)

APPLY TO

- Airports intended for use at night and that can not be easily identified from the air by other means;
- Used to specifically identify the presence of an aerodrome.

CERTIFICATIONS

- ICAO test report (EN 17025 Laboratory) NR. 466-QL19-R02
- CE marking

COMPLIANCE

- ICAO Aerodromes -Annex 14 Volume 1, Par. 5.3.3 "Aeronautical Beacon"



IDENTIFICATION BEACON TECHNICAL DRAWING

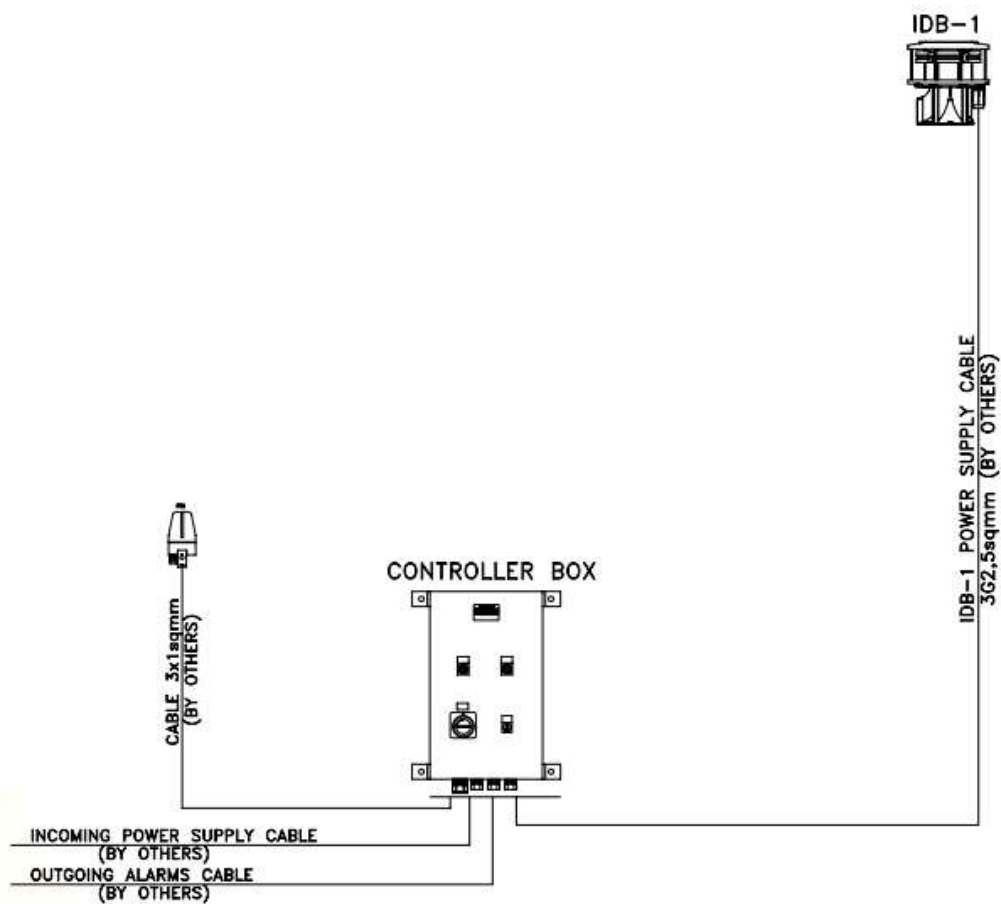



IDENTIFICATION BEACON TECHNICAL DRAWING

BEACON DETAIL

BEACON FRONT VIEW

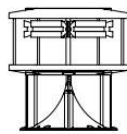

BEACON SIDE VIEW

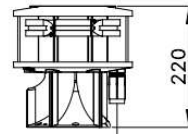

INCOMING POWER SUPPLY CABLE
C/W CONNECTOR (CABLE O.D. 7/14mm, Max size 2.5sqmm)

BEACON TOP VIEW



FIXING DETAILS

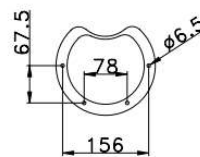

PANEL DETAIL



FRONT VIEW

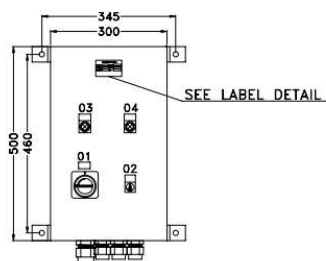

SIDE VIEW

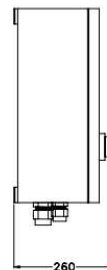

BOTTOM VIEW

